

eco 4000 AD

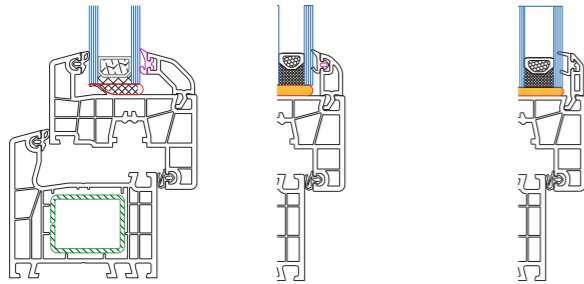

Ug - Wert	1,1 W/m ² K	0,7 W/m ² K	0,6 W/m ² K
Psi - Wert	0,066 W/mK	0,064 W/mK	0,048 W/mK
Uw - Wert	1,29 W/m ² K	1,01 W/m ² K	0,90 W/m ² K

eco 5000 MD ratio fv

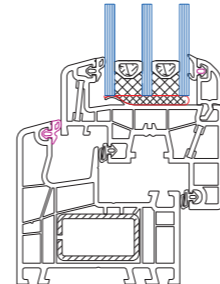

Ug - Wert	0,7 W/m ² K
Psi - Wert	0,064 W/mK
Uw - Wert	0,97 W/m ² K

energeto[®]

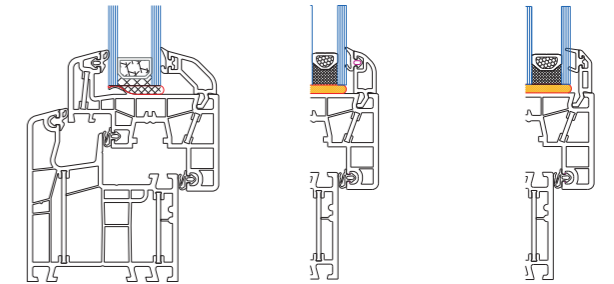

Ug - Wert	1,1 W/m ² K	0,7 W/m ² K	0,6 W/m ² K
Psi - Wert	0,066 W/mK	0,064 W/mK	0,048 W/mK
Uw - Wert	1,24 W/m ² K	0,95 W/m ² K	0,84 W/m ² K

eco 8000 passiv

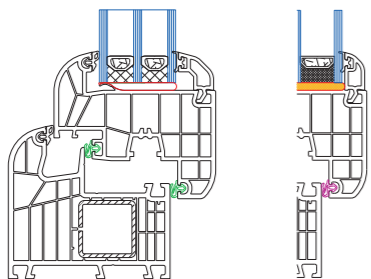

Ug - Wert	0,6 W/m ² K	0,5 W/m ² K
Psi - Wert	0,048 W/mK	0,048 W/mK
Uw - Wert	0,85 W/m ² K	0,78 W/m ² K

eco 5000 MD ratio hfv

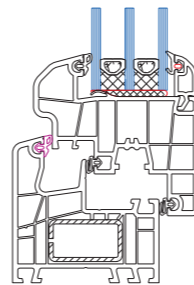

Ug - Wert	0,7 W/m ² K
Psi - Wert	0,064 W/mK
Uw - Wert	0,98 W/m ² K

eco 5000 MD (keine Klebetechnik)

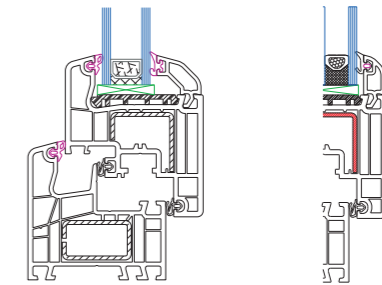

Ug - Wert	1,1 W/m ² K	0,7 W/m ² K
Psi - Wert	0,066 W/mK	0,064 W/mK
Uw - Wert	1,29 W/m ² K	1,01 W/m ² K